

Application No:

DC/22/00416

Address:

Land Adjacent North

Roundabout

A140 Ipswich Road

Brome

Part In The Parish Of

Thrandeston

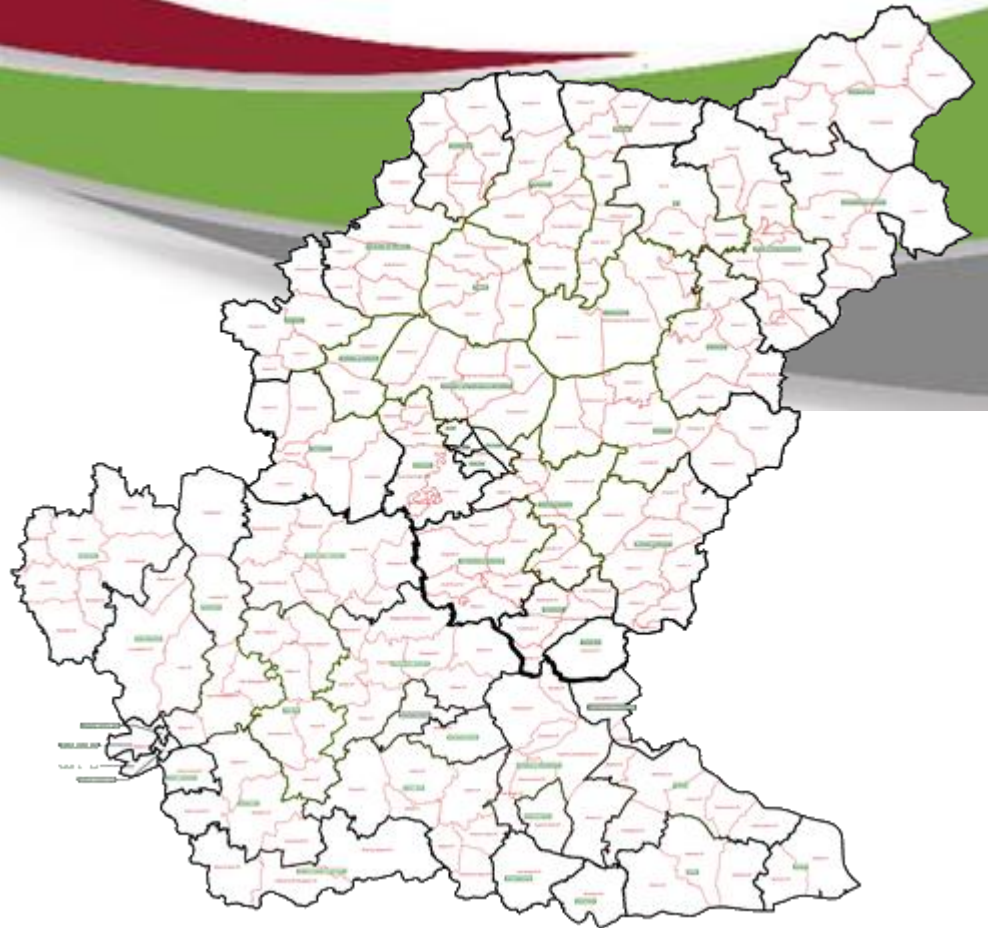

Site Location

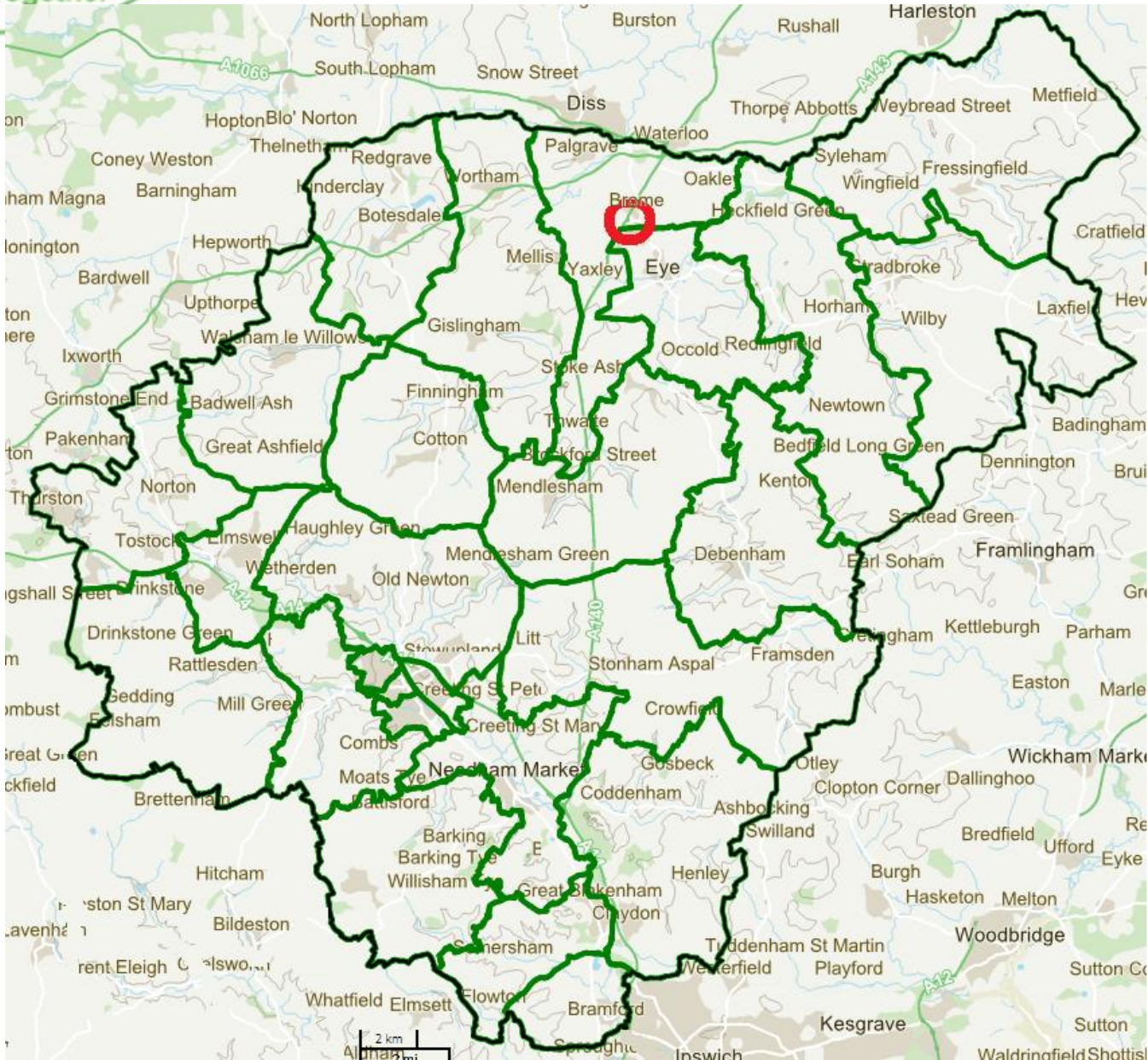

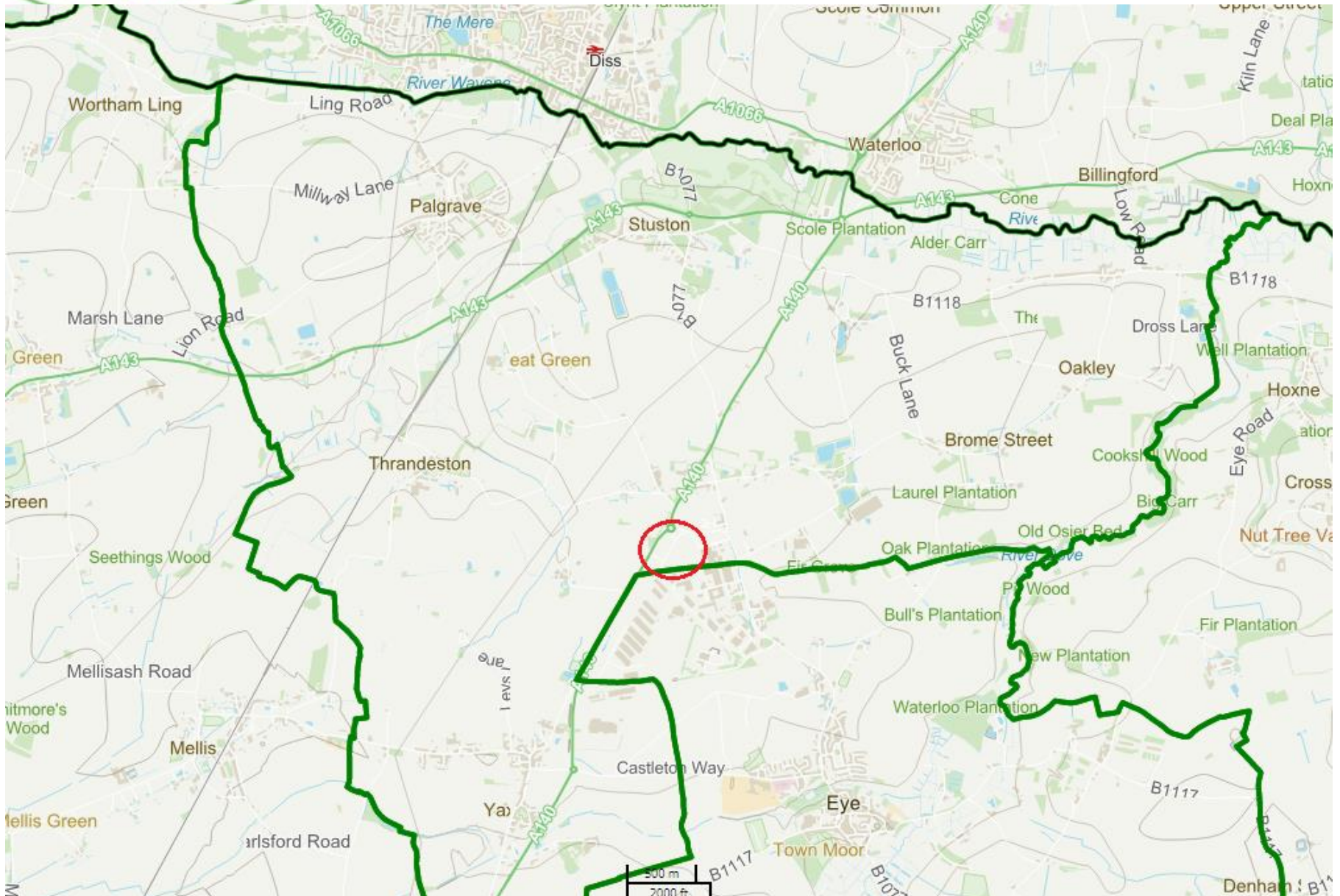

Aerial Map – wider view

Slide 4

© Crown copyright and database rights 2021 Ordnance Survey 0100017810 & 0100023274.





Constraints Map

-  Grade II
-  Footpath



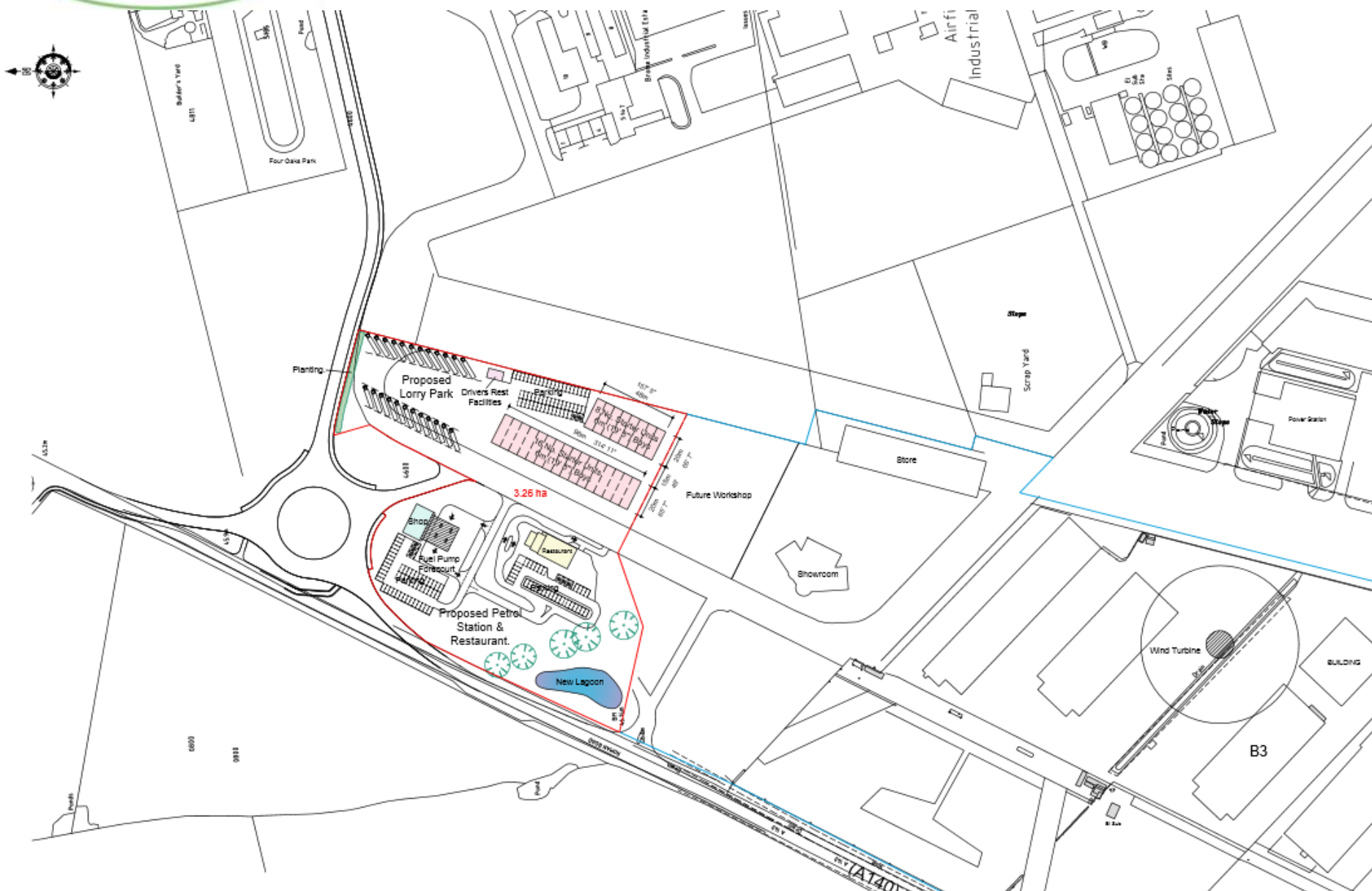

Indicative Site Layout



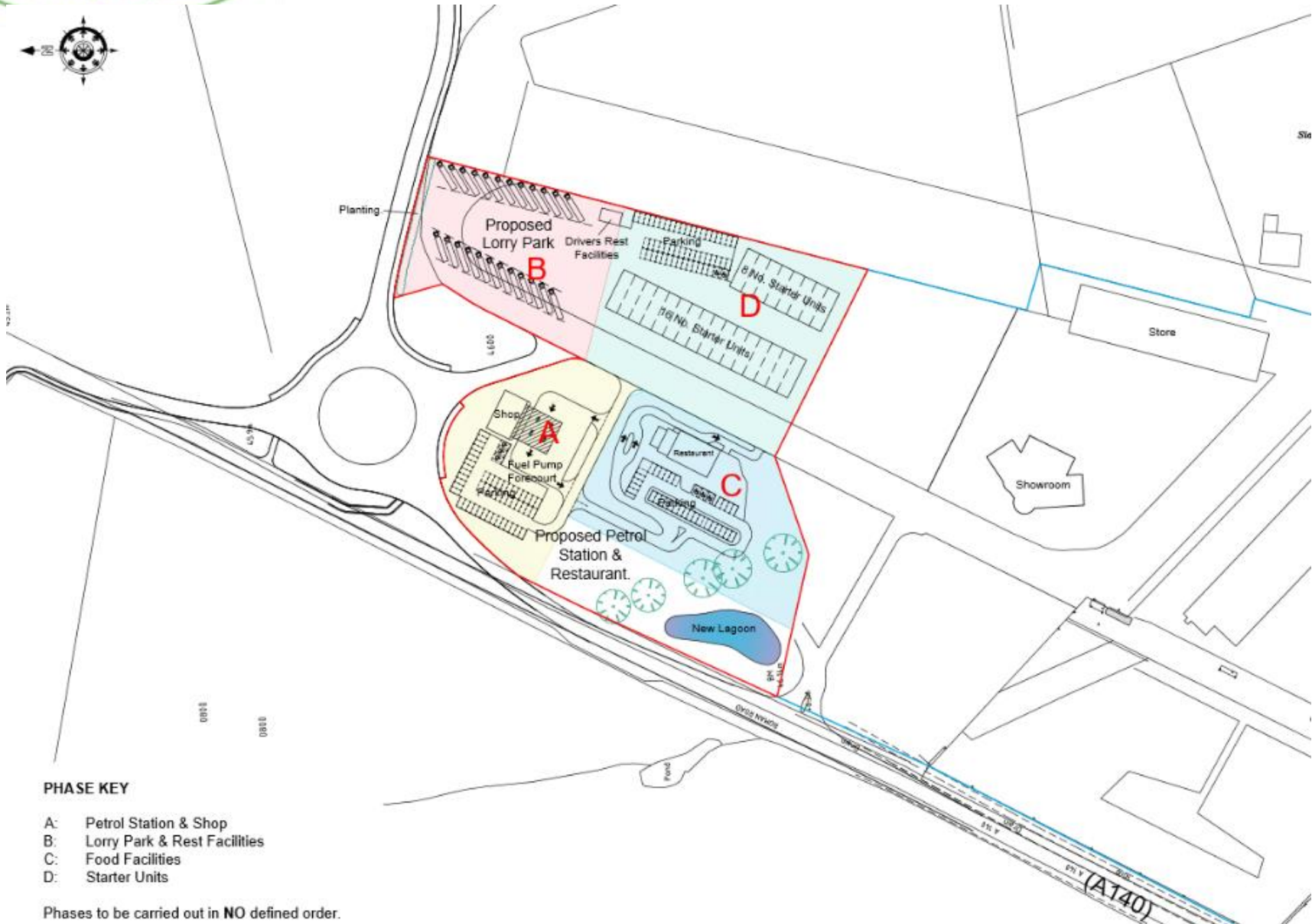

PHASE KEY

- A: Petrol Station & Shop
- B: Lorry Park & Rest Facilities
- C: Food Facilities
- D: Starter Units

Phases to be carried out in **NO** defined order.

